

**CHARACTERISTICS/TESTS**

In accordance with ANSI C29.9

Glaze: Light-grey Munsell Notations N°70  
 Approximate weight

16.9 lbs

**DIMENSIONS**

Minimum leakage distance

15.5 in

**MECHANICAL VALUES**

Cantilever breaking strength, upright 2000 lbs  
 Cantilever breaking strength, underhung 2000 lbs  
 Tensile breaking strength 8500 lbs  
 Torsional breaking moment 7000 in.lbs  
 Compression breaking strength 10000 lbs

**ELECTRICAL VALUES**

Guaranteed voltage:  
 Critical impulse dry, wave 1.2/50 - positive polarity 125 kV  
 Power frequency wet, withstand 45 kV  
 Impulse dry, wave 1.2/50 - withstand, positive polarity 110 kV

Test voltage 10 kV  
 Maxi RIV at 1 MHz 50 μV

**GENERAL TOLERANCE**

± (0.04d + 0.06) in., if d ≤ 11.8 in.  
 ± (0.025d + 0.24) in., if d > 11.8 in.

**CONVERSION TABLE**

DIMENSIONS	1.	mm	0.03937	inch
		25.4	mm	1
FORCE	1	N	0.22481	pound
	4.448	N	1	pound
MOMENT OF FORCE	1	Nm	8.8495	inch-pound
	0.113	Nm	1	inch-pound

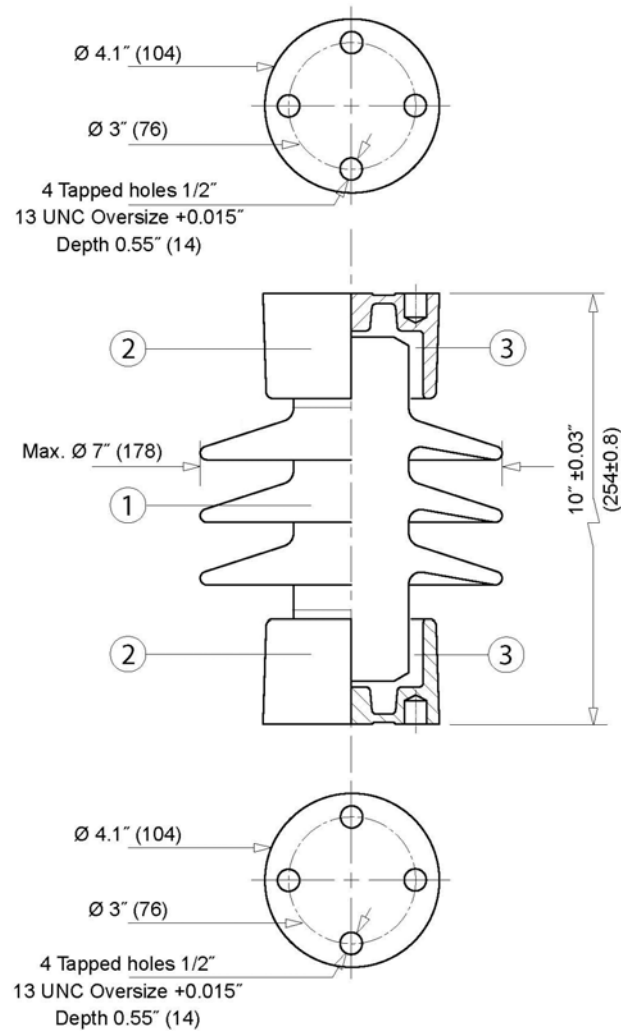

1	Porcelain	Glazed Light-grey
2	Cap Fitting	K-076-043-112
3	Cementing	Portland cement
4	/	/
5	/	/
6	/	/
7	/	/
Nb	DESIGNATION	MATERIAL

Top and bottom bolts are not furnished

1	S-05012	Issue 1
/	/	/
Qty	REFERENCE	DESIGNATION

MODIFICATIONS	/			
	/			
	/			
	/			
	/			
	/			

**Outdoor post insulator**

Cat. ID.

**110 SU**

**TR-205**



**Meister International, LLC**

Tel: 513-923-2712  
 sales@meisterintl.com

Fax: 513-923-1978  
 www.meisterintl.com