

⚠	1	1	654127	2 HOLE SPADE	COPPER, CB3300
	2	1	553001	GASKET	NITRILE (BUNA-N)
	3	1	231890	BUSHING	PORCELAIN
⚠	4	1	604415	STUD	COPPER, C11000
	5	2	506362	CLAMP SET	SILICON BRONZE
	6	1	553144	GASKET	NITRILE (BUNA-N)
	7	1	580392	SPECIAL WASHER	BRASS
⚠	8	1	585040	SINGLE COIL LOCK WASHER	SILICON BRONZE
⚠	9	3	570400	HEX NUT	BRASS

.44 D. HOLES ON 5.50 D. B.C.

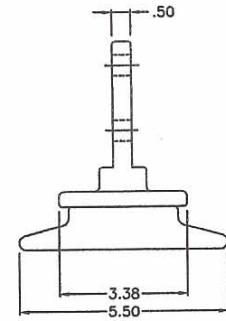
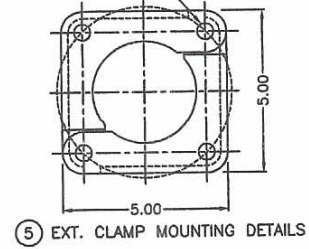

RATINGS: (OIL TO AIR APPLICATION)

34.5 kV. CLASS

200 kV. B.I.L.

125 AMPERES

NOTES:

1. THE COPPER STUD AND TIN PLATED SPADE ARE JOINED BY SOLDERING.
2. PORCELAIN COLOR - GRAY SEMI-CONDUCTIVE GLAZE - DARK BROWN
3. LEAKAGE DISTANCE - 47"
4. ALL DIMENSIONS IN INCHES.
5. ELECTRODAG 213 IN GASKET SEAT.
6. RATINGS GIVEN ARE BASED ON USE IN A LIQUID FILLED TRANSFORMER WITH LOWER END OF BUSHING UNDER OIL LEVEL. FOR MAXIMUM PERFORMANCE OF BUSHING, THE GAP BETWEEN THE PORCELAIN AND THE STUD MUST BE FLOODED WITH OIL. IN ORDER TO FLOOD, THE BUSHING MUST BE MOUNTED ON THE APPARATUS, THEN EVACUATED TO 5mm VACUUM WHILE THE EQUIPMENT IS BEING FILLED WITH OIL.