

TECHICAL REQUIREMENTS

- | | |
|------------------------------|--------------------|
| 1. CANTILEVER STRENGTH: | 1500# [7.5KN] |
| 2. TENSILE STRENGTH: | 5000# [22.7KN] |
| 3. TORSION STRENGTH: | 6000" # [27.2KN.M] |
| 4. COMPRESSION STRENGTH: | 30000# [136KN] |
| 5. NEMA VOLTAGE RATING: | 23KV |
| 6. 50 HERTZ WITHSTAND-DRY: | 60KV |
| 7. 50 HERTZ WITHSTAND-DEW: | 40KV |
| 8. IMPULSE WITHSTAND: | 150KV |
| 9. GLAZE: ANSI 70 LIGHT GREY | |
| 10. APPLICABLE STANDARD: | ANSI C29.10-1989 |

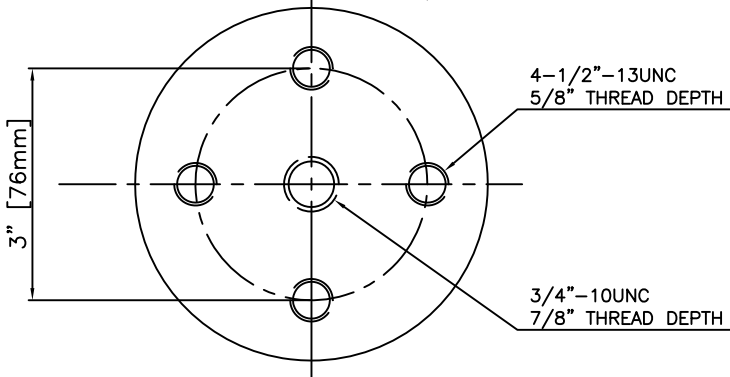

Meister International, LLC

P.O. Box 338, Ross, OH 45061 USA
 Phone: (513) 923-2712 Fax: (513) 923-1978
 Email: Sales@MeisterIntl.com
 Web: MeisterIntl.com

PART NO. A30-5
 INDOOR BUS SUPPORT