

TECHICAL REQUIREMENTS

- |                              |                  |
|------------------------------|------------------|
| 1. CANTILEVER STRENGTH:      | 2000# [9.1KN]    |
| 2. TENSILE STRENGTH:         | 5000# [22.7KN]   |
| 3. TORSION STRENGTH:         | 6000# [27.2KN.M] |
| 4. COMPRESSION STRENGTH:     | 30000# [136KN]   |
| 5. NEMA. VOLTAGE RATING:     | 14.4KV           |
| 6. 50 HERTZ WITHSTAND-DRY:   | 50KV             |
| 7. 50 HERTZ WITHSTAND-DEW:   | 30KV             |
| 8. IMPULSE WITHSTAND:        | 110KV            |
| 9. GLAZE: ANSI 70 LIGHT GREY |                  |
| 10. APPLICABLE STANDARD:     | ANSI C29.10-1989 |

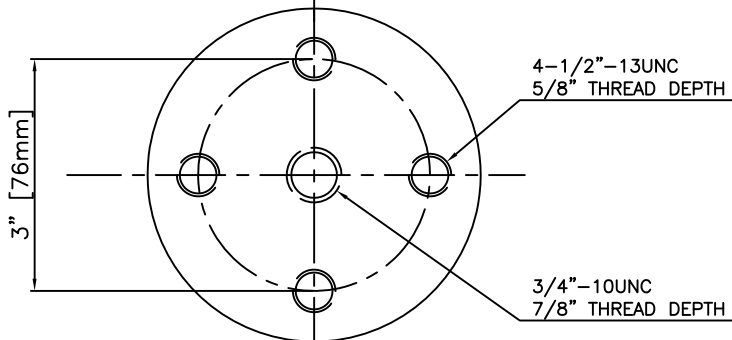

**Meister** International, LLC

P.O. Box 338, Ross, OH 45061 USA  
 Phone: (513) 923-2712 Fax: (513) 923-1978  
 Email: Sales@MeisterIntl.com  
 Web: MeisterIntl.com

PART NO. A30-4  
 INDOOR BUS SUPPORT