

TECHICAL REQIREMENTS

- | | |
|---|--------------------|
| 1. CANTILEVER STRENGTH: | 1250# [5.69KN] |
| 2. TENSILE STRENGTH: | 3000# [13.7KN] |
| 3. TORSION STRENGTH: | 3500" # [0.41KN.M] |
| 4. COMPRESSION STRENGTH: | 20000# [91KN] |
| 5. NEMA. VOLTAGE RATING: | 13.2KV |
| 6. 50 HERTZ WITHSTAND-DRY: | 36KV |
| 7. 50 HERTZ WITHSTAND-DEW: | 26KV |
| 8. IMPULSE WITHSTAND: | 95KV |
| 9. GLAZE: ANSI 70 LIGHT GREY | |
| 10. APPLICABLE STANDARD: ANSI C29.10-1989 | |

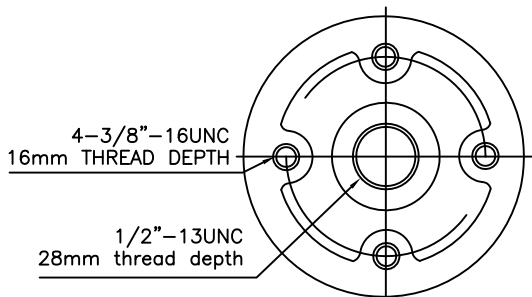

P.O. Box 338, Ross, OH 45061 USA
 Phone: (513) 923-2712 Fax: (513) 923-1978
 Email: Sales@MeisterIntl.com
 Web: MeisterIntl.com

PART NO. A20-3
 INDOOR BUS SUPPORT